



Attn: Bonita Oswald
1120 SW Fifth Avenue, Suite 405
Portland, Oregon 97204



Bull Run TREATMENT PROJECTS

***Our water: safe and abundant
for generations to come.***

Construction on Bull Run Filtration builds momentum

Hundreds of skilled workers are back on the job working on the filtration facility and associated pipelines. Construction is well underway to build the facility. When complete, the Bull Run Filtration Project will provide cleaner, safer drinking water to protect public health and comply with federal and state drinking water regulations.



Facility site construction, August 2025

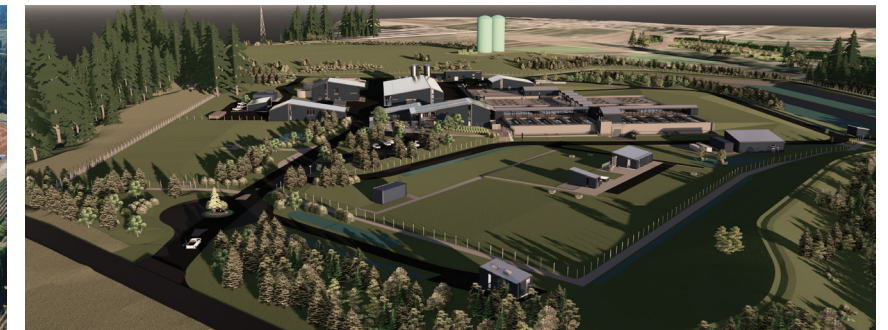

This conceptual rendering shows what we are building towards.

Pipelines Ensuring a Reliable Water Supply for Everyone

Our crews have now laid more than 2,600 feet of resilient 66-inch pipes along Dodge Park Boulevard. When finished, nearly 22,150 feet of new pipeline will connect the new filtration facility to our existing Bull Run water system. We are also working to begin installing another 8,900 feet of pipe to bring raw water to the facility, including a section of 72-inch pipe that we are tunneling 235 feet below the surface. We're also partnering with the Pleasant Home Water District and have installed nearly 4,000 feet of their 6- to 8-inch water mains. All of these pipes will help build a stronger, more resilient water system for the entire region. Thank you for your continued patience as we move forward with this vital project.

Upcoming Events

- Bull Run Filtration Community Open Houses**
- Oct. 9, 2025: Sandy: 9-10:30 a.m.
 - Oct. 9, 2025: Gresham: 6-8 p.m.

- Bull Run Filtration Coffee with the Contractor**
- Nov. 13, 2025: 9-10:30 a.m.

Learn more: portland.gov/filtration



Bull Run TREATMENT PROJECTS | Filtration

Learn More:

portland.gov/filtration

Contact:

Bonita Oswald
Portland Water Bureau
Project Communications
503-823-1505

bullrunprojects@portlandoregon.gov

Scan QR code to sign up for Bull Run Filtration e-news or text alerts:

- Latest news and updates
- Notice of traffic or sound impacts
- Subscribe: portland.gov/brtpnews



The City of Portland is committed to providing meaningful access. To request translation, interpretation, modifications, accommodations, or other auxiliary aids or services, contact 503-865-6688, Relay: 711.

Traducción e Interpretación | Biên Dịch và Thông Dịch | 口笔译服务 | अनुवादन तथा व्याख्या | Устный и письменный перевод | Turjumaad iyo Fasiraad | Письмовий і усний переклад | Traducere și interpretariat | Chiaku me Awewen Karas | Translation and Interpretation: 503-865-6688 (Relay: 711) | portland.gov/water/access



Typical open cut pipeline construction starts with excavation, then pipelaying, and backfilling.

Robust traffic management plan in place to protect safety

Construction of new pipes in the right-of-way will occur in phases to enhance coordination, improve efficiency, and reduce construction impacts. As project construction activity increases, commuters and residents can expect more traffic from passenger vehicles and trucks. A comprehensive traffic control plan is in place to protect the safety of community members, the traveling public, and work crews. We appreciate the community's patience and remind all drivers to use extra caution in construction zones as we work to complete this important project.

Get the updates on the Bull Run Treatment Project delivered straight to you.

Scan the QR code to sign up for **email updates** to receive monthly project news, neighbor notifications about traffic, noise, or construction activity, meeting invitations, and important blasting alerts. You can also opt in for **text notifications** to receive updates and alerts conveniently on your mobile device regarding construction traffic and any blasting activity.



See the map below for anticipated timing of the different project phases. This is a proposed schedule and subject to change based on weather and other field conditions.

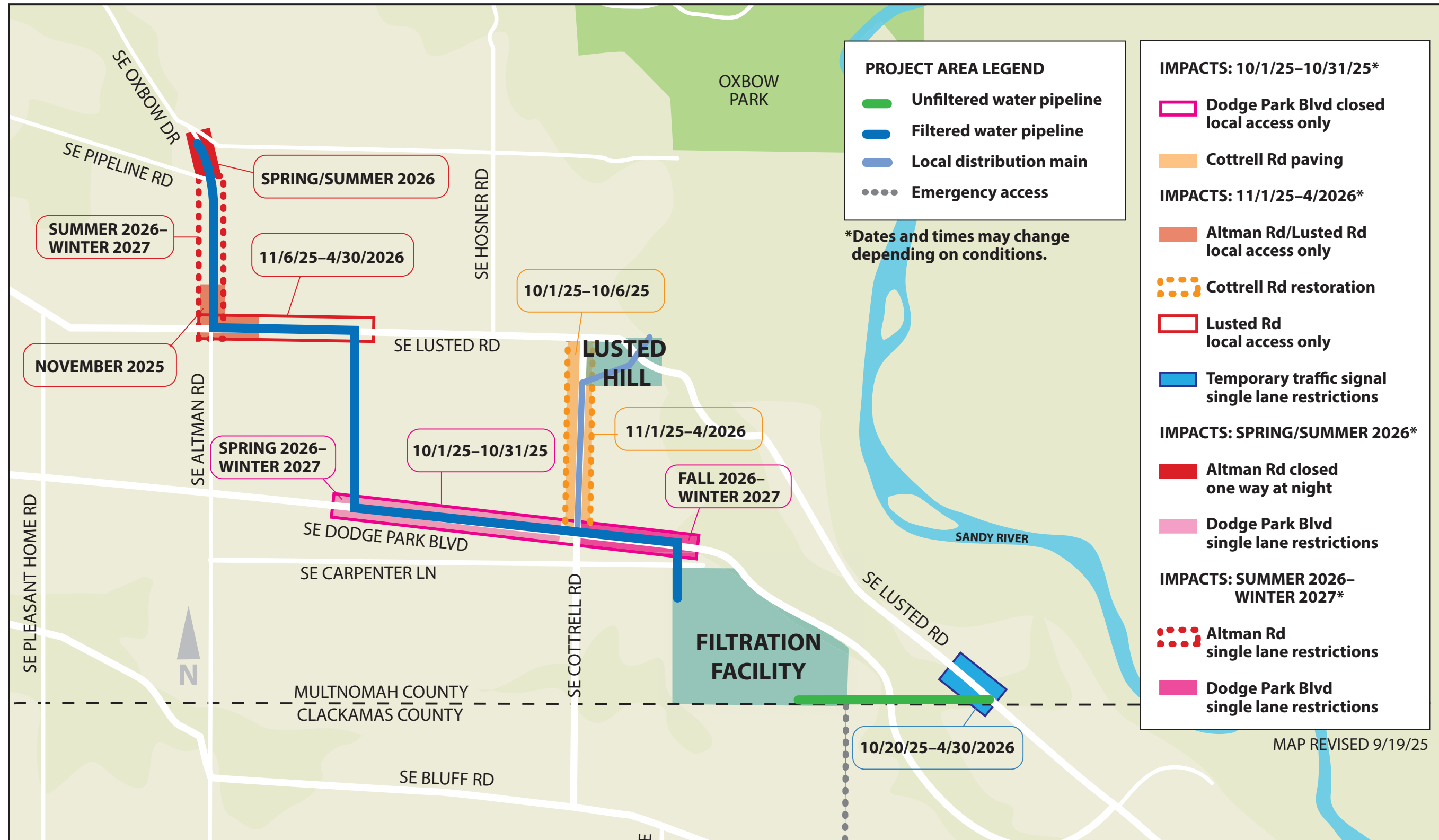

What to expect

- Before we begin work, we will survey for other utilities.
- Work hours will be Monday to Saturday, 7 a.m. to 6 p.m.
- The streets may be closed to all but local, emergency, and bus traffic.
- Mail, garbage, and delivery services will have access.
- Water Bureau and Pleasant Home Water District customers in the project area may experience temporary water disruption. We will put a notice on your front door the day before the shutoff if you are impacted.
- Work may cause noise, dust, and traffic delays.
- Street parking may be limited. We may need to leave some equipment overnight.

MAP REVISED 9/19/25