

Plot Date: 1/12/2012 11:23:43 AM File name: U:\vststation\DN\N\CTY OF PORTLAND - STANDARD DRAWINGS\SECTION DIVISIONS\3-STREETS\MICROSTATION\STD DRAWING NO P-450\LOT_SHT_P-450.dgn

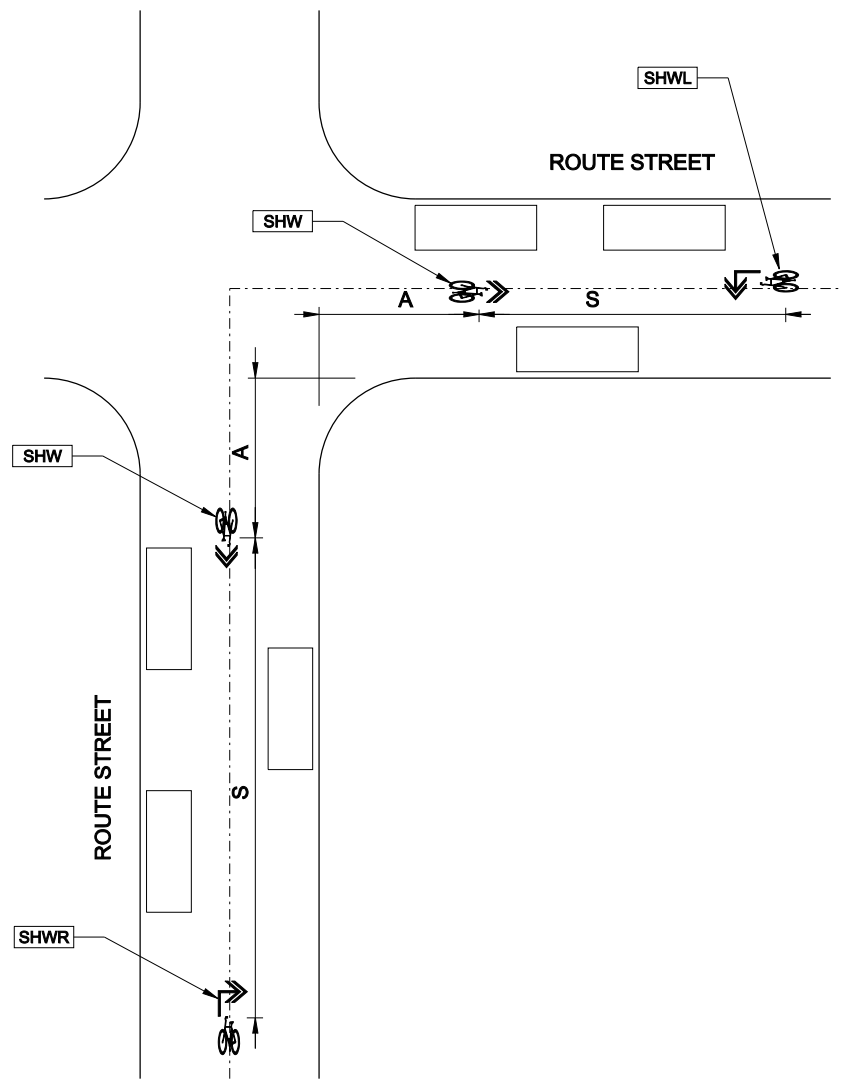

BEND IN ROUTE LAYOUT

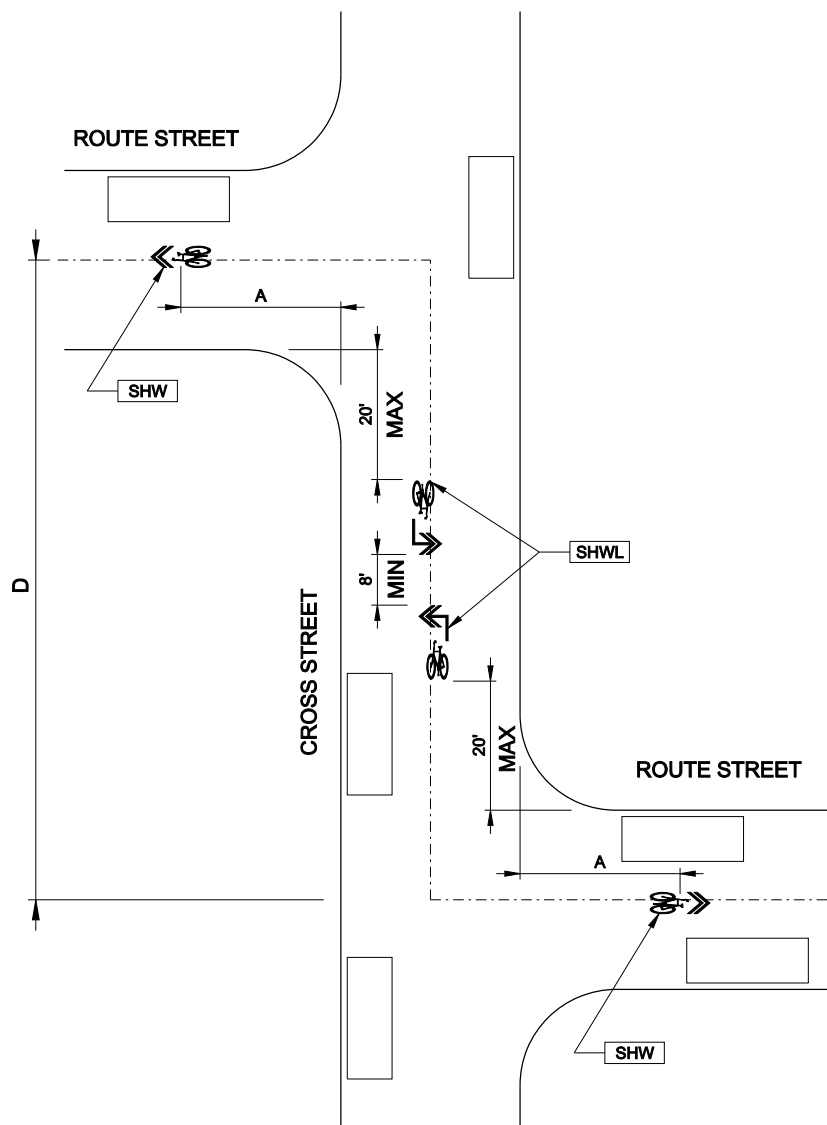

JOG IN ROUTE LAYOUT

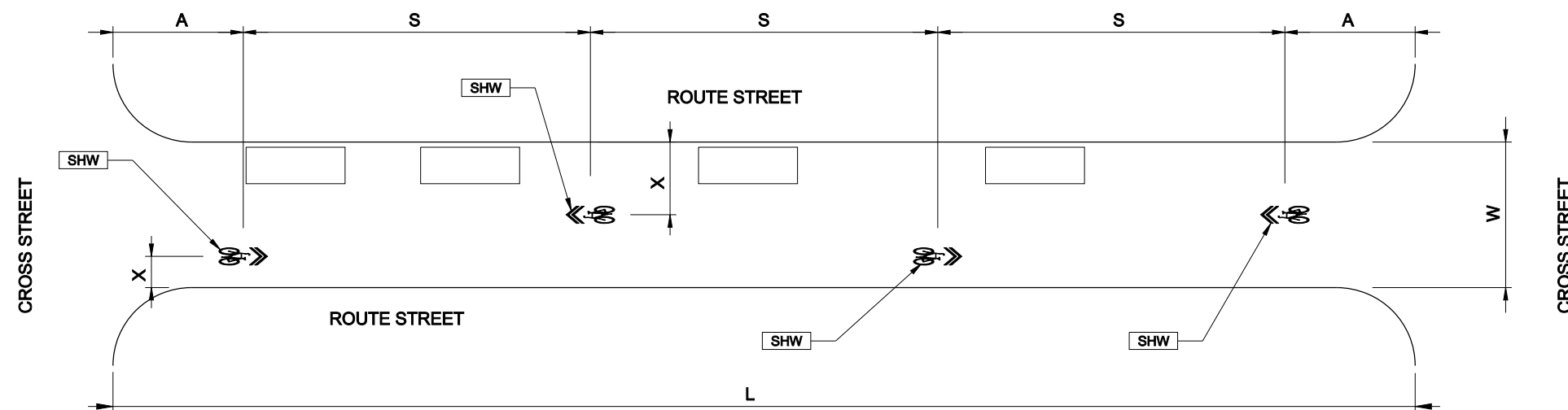

GENERAL LAYOUT

CURB OFFSETS TABLE			
STREET WIDTH (W)	CURB OFFSET (X)		
	ON-STREET PARKING BOTH SIDES	ON-STREET PARKING ONE SIDE	NO PARKING
18'		12.0' / 4.0'	5.5'
20'		13.0' / 5.0'	6.0'
22'		14.0' / 6.0'	6.5'
24'	11.5'	15.0' / 7.0'	
26'	12.5'	13.5' / 5.5'	
28'	13.5'	14.0' / 6.0'	
30'	14.5'		
32'	13.0'		
34'	13.5'		
36'	14.0'		

NUMBER AND SPACING TABLE	
BLOCK/SEGMENT LENGTH (L)	NUMBER OF SHARROWS (N)
0' - 450'	2
451' - 700'	4
701' - 950'	6
951' - 1300'	8
1301' - 1650'	10
1651' - 2000'	12
2001' - 2350'	14
SPACING (S)	$S = (L - 50) / (N - 1)$

GENERAL NOTES:

1. OFFSETS "X" ARE MEASURED FROM FACE OF CURB TO CENTERLINE OF SHARROW.
2. SPACINGS "S" ARE MEASURED FROM CENTER OF SHARROW TO CENTER OF SHARROW.
3. "N" REPRESENTS THE TOTAL NUMBER OF SHARROWS NEEDED FOR THE SEGMENT.
4. ADJUST SPACINGS AS NECESSARY TO AVOID SHARROW PLACEMENT WITHIN INTERSECTIONS OR IN FRONT OF DRIVEWAYS.
5. "A" SHALL BE LARGE ENOUGH SO THAT THE ENTIRE FIRST SHARROW LIES BEYOND THE SIDEWALK CORRIDOR OF THE CROSS STREET.
TYPICAL "A" = 25'
MAXIMUM "A" = 50'
6. WHEN "D" < 75': IF SHARROWS ON ROUTE STREET ARE VISIBLE FROM THE OPPOSING LEGS, THEN OMIT SHARROWS ON CROSS STREET.
7. WHEN "D" > 450': USE "BEND IN ROUTE" DETAIL.
8. UNIQUE CROSSING TREATMENT IS REQUIRED FOR CROSS STREETS WITH A CLASSIFICATION OF "NEIGHBORHOOD COLLECTOR" OR HIGHER AND/OR AN ADT > 3,000VPD.

LEGEND

- CURB
- - - ROUTE CENTERLINE
- ▭ PARKED CAR
- XXX PBOT REFERENCE MARKER

The selection and use of this Standard Drawing, while designed in accordance with generally accepted engineering principles and practices, is the sole responsibility of the user.



Standard Drawing Title

**SHARED LANE PAVEMENT MARKINGS
- LOCAL SERVICE STREETS**

Note:
All material and workmanship shall be in accordance with the City of Portland Standard Construction Specifications.

Effective Date: 01-11-12

Calc. Book No.:

Baseline Report Date:

Standard Drawing No.

P-450