

- (L)** Right-of-way configuration with dimensions of curb, furnishing zone, sidewalk, and frontage zone.
- (M)** Driveway width.
- (N)** Street name.
- (O)** Location of utility poles, streetlights, fire hydrants, signs, meters, and other objects located in right-of-way.
- (P)** Existing and proposed locations of utility connections from right-of-way to building. Indicate size, material, location, distance to adjacent services, and (N) new/(E) existing.
- (Q)** Location and size of utility mains in right-of-way, including location of connections to property on both sides of the street. Specify combination, sanitary and/or storm sewer mains and method of connection (e.g. connect to existing public lateral or contractor tap to main line).
- (R)** Proposed new street tree, including species and size.
- (S)** Existing street tree to be retained, including species and size. Include location tree protection fencing inside curb, sidewalk, and proposed utility connections.
- (T)** Existing street tree to be removed, including species and size. Indicate with "X" through tree symbol.
- (U)** White space for City stamps

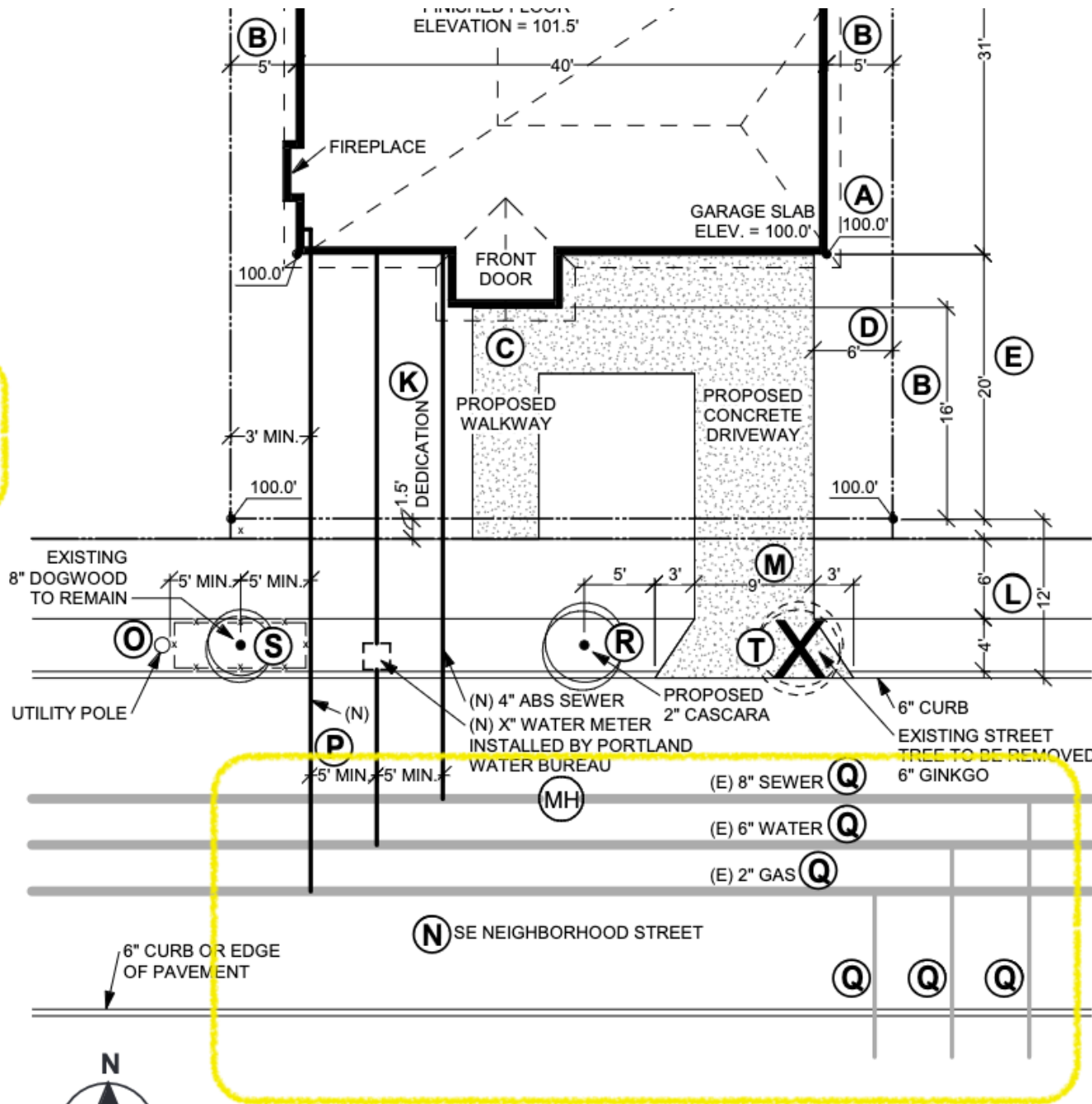

<b>LOT AREA</b> .....	5,000 SQ FT
<b>IMPERVIOUS AREA</b>	
DRIVEWAY .....	1,800 SQ FT
PATIO .....	100 SQ FT
WALK .....	190 SQ FT
ROOF AREA .....	1,134 SQ FT
<b>TOTAL</b> .....	<b>1,804 SQ FT</b>
<b>UTILITY LOCATE NUMBER</b>	
Call 811 or <a href="http://digsafelyoregon.com">digsafelyoregon.com</a>	
#123456	



**SITE PLAN** SCALE 1" = 10'