



Site Plan Checklist

Site/Plot plan must be accurately drawn to scale and show:

- Lot and building setback dimensions
- Property corner elevations
(If there is more than a 4 foot elevation differential, the site plan must also show existing and proposed contour lines at 2 foot intervals. A separate Grading Plan may be required to legibly show grading changes.)
- Location and dimensions of easements and driveway
- Footprint of proposed and existing structures (including decks)
- Dimension distances between structures and property
- Location of wells and/or septic systems
- Lot area
- North Arrow
- Impervious area (structures, paving, roof overhangs, etc.)

- Location of utilities and connections (storm and sanitary sewers, water, gas, etc., including size of service and street location)
- Location of stormwater facility
- Surface drainage
- Width of adjacent right of way and curb height
- Landscape plans
- Minimum scale is 1 inch = 10 feet
- Minimum paper size is 11 x 17 inches
- Allow sufficient white space for City approval stamps and notes
- Any additional requirements specific to your site or project (if required, see Development Services Center staff for any specific requirements needed for your site or project)
- Show Water Bureau required backflow assembly locations. Water Bureau required backflow assemblies are to be installed on private property at the property line, on the centerline of the city water service. If installed inside buildings having a zero setback, backflow assemblies are to be installed immediately at the service entrance to the building. See "[Backflow Assembly Installation Requirements](#)" for further details regarding inside backflow assembly installations.**

NOTES:

DEMO EXISTING SINGLE FAMILY HOUSE

24" Φ EXISTING BIG LEAF MAPLE TO BE REMOVED

PROJECT LEGAL
PARCEL 7, PARTITION PLAT
1992-3AX, MAP 1S-1E276E
TL-R-00794375

WATER BUREAU
MARK BACKFLOW ASSEMBLY
LOCATION WHEN REQUIRED WHERE
WATER SERVICE ENTERS PROPERTY

PROJECT ADDRESS
3030 S.E. 125TH AVE
PORTLAND, OR 97207

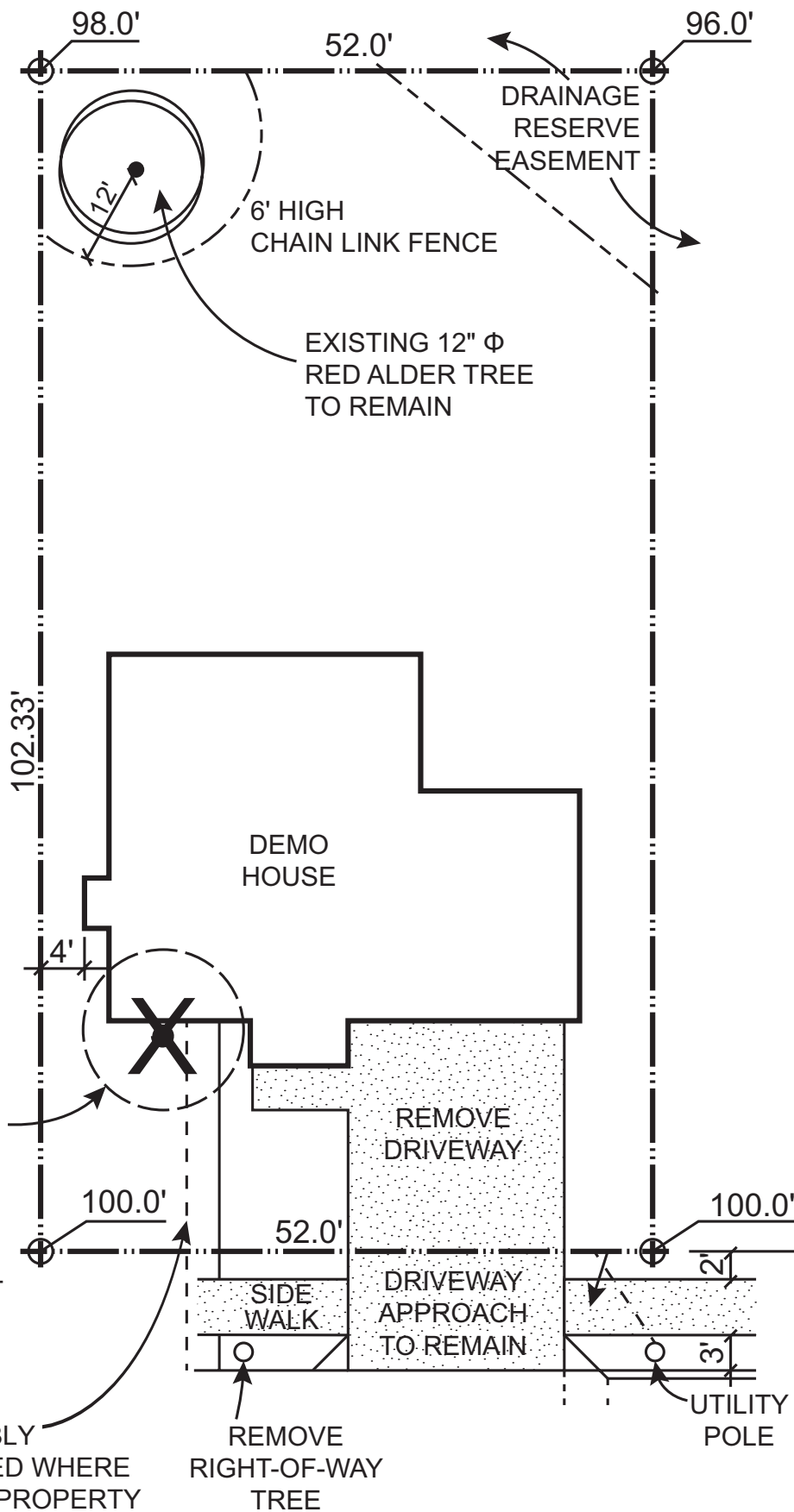

Sample Site Plan

Site Plans must be clearly legible and reproducible.

This sample drawing has been designed to help you prepare a complete Site Plan for your project. Make sure your Site Plan includes all the information on the Site Plan Checklist.

PLEASE NOTE:

The sample site plan to the left is provided as a reference tool showing how and what must be included in your site plan.

This sample site plan is not to scale, nor is it the size that we require you to submit. We require an 11 x 17 inch sheet.

Your site plan must be to scale. Our required scale is minimum 1 inch = 10 feet.

You may draw your site plan on the reverse side of this sheet.



SITE PLAN

SCALE 1" = 10'

IMPERVIOUS AREA

DRIVEWAY _____

PATIO _____

WALK _____

ROOF AREA
(INCL. OVERHANG) _____

TOTAL _____

BUILDING COVERAGE

BUILDING FOOTPRINT _____

LOT AREA



PROJECT LEGAL

PROJECT ADDRESS

SITE PLAN

SCALE 1" = 10'

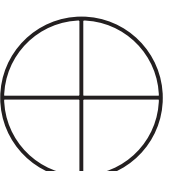
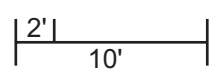

**NORTH
ARROW**